

Ballina Shire Pools Redevelopment

Ballina Shire Council is planning a redevelopment of its aquatic facilities in both Alstonville and Ballina. Following comprehensive community consultations undertaken last year, a study and delivery plan has been completed and the design concept for each facility has been endorsed by the Council. The process of obtaining the relevant planning approvals and finalising the design and construction tender documentation is now underway.

It is envisaged that Council will be in position to award the successful tender/s by November 2016, with construction work to follow on both pools commencing concurrently in March 2017. The pools would then reopen for the commencement of the swimming season in September 2017.

Ballina Project Concept

The key elements for the redevelopment are:

- Replacement and relocation of existing amenities to the south west corner of the site to create a safer arrival for pool patrons and safer supervision of swimmers for lifeguards. This relocation will focus attention on visitors as well as locals, providing an exceptional outlook. Establishment of a commercial coffee shop space with spectacular river views will assist in providing additional wind protection for pool users.
- Replacement of existing seven lane 50m cold water pool with a larger FINA compliant 50m x 25m heated pool, with ten lanes at 2.5m wide, suitable for competition swimming. This new pool will allow 'across pool' playing of water polo games and enables lap swimming to continue at the same time in a 25m 'across pool' configuration, maximising pool usage. A 25m access ramp offers safe entry for persons with a disability.
- Replacement of existing training pool with a 25m x 10m heated and enclosable Learn to Swim pool with beach entry. This pool will provide a safe swimming area for children and enable consistent all-weather learn to swim programs for children and rehabilitation exercise for people of all ages.
- Replacement of toddler's pool with a contemporary wet play area.
- Replacement of existing riverfront fencing with high quality transparent screening to provide wind protection and maximise views of the river.

Alstonville Project Concept

The key elements for the redevelopment are:

- Replacement of existing pools in approximately the same locations as the current configuration on the property.
- Replacement of existing seven lane 50m pool with a larger FINA compliant 50m x 25m heated pool, consisting of ten lanes at 2.5m wide, suitable for competition swimming.
- The new pool allows for 'across pool' playing of water polo games and lap swimming to continue at the same time in a 25m 'across pool' configuration, maximising pool usage. The new pool also includes an access ramp to enable safe entry for persons with a disability.
- Replacement of existing training pool with a 25m x 10m heated and enclosable Learn to Swim pool with beach entry. This pool provides a safe swimming area for our children and enables consistent all-weather learn to swim programs for children and rehabilitation exercise for people of all ages.
- Replacement of toddler's pool with a contemporary wet play area.
- Upgrade of filtration and backwash to sewer facilities to improve environmental outcomes.

Ballina Pool Concept Plan



Alstonville Pool Concept Plan

©2015 - THIS DRAWING REMAINS THE PROPERTY OF GREENLIGHT DESIGN

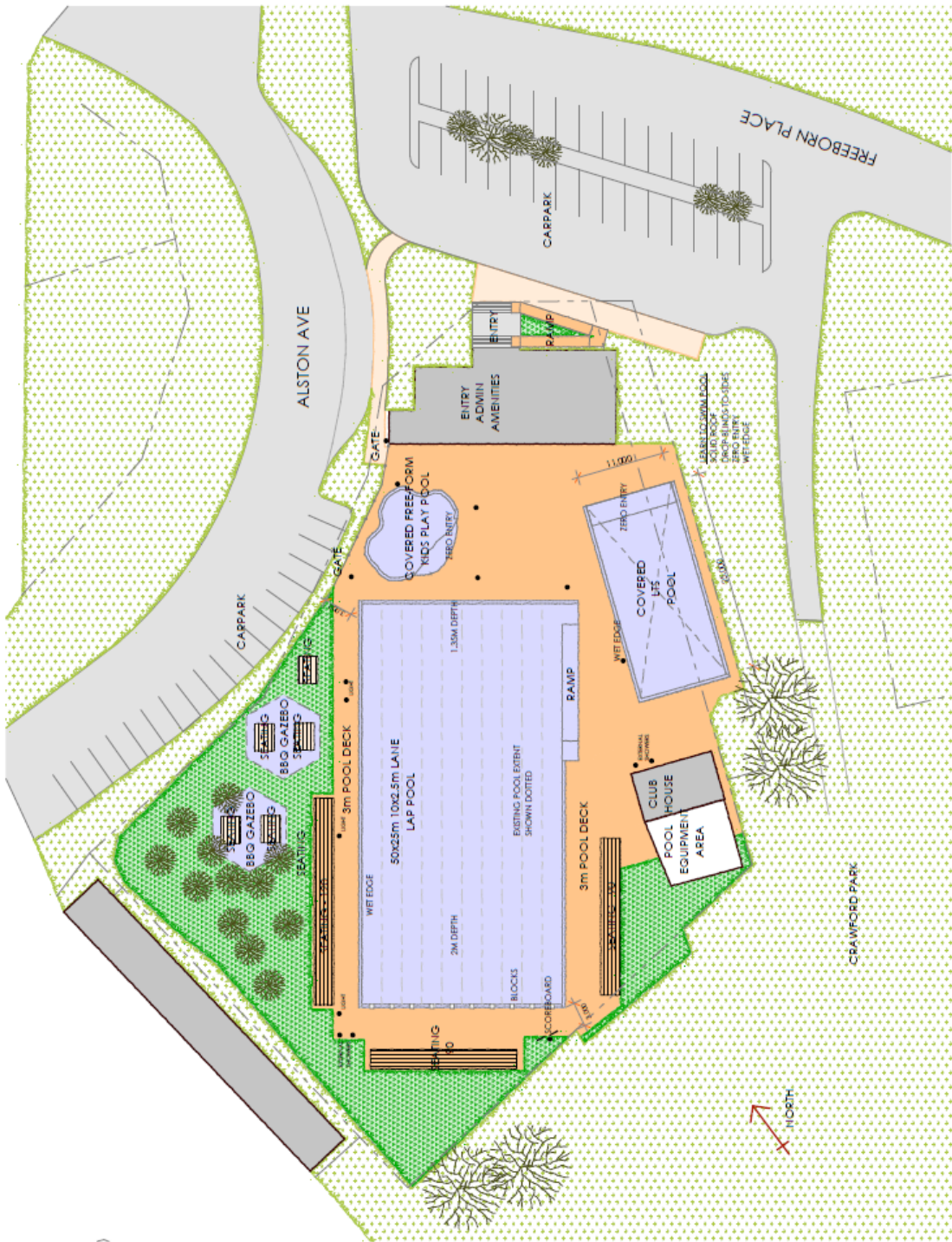

Option Four

1:500

For Review	25/01/16
For Review	22/11/16
For Review	9/10/16
Rev	Date

Date	Mar 2015	Scale	1:500	Project	Proposed Arrangement Four
Sketch Number	AP SK04 C				Alstonville Pool
80mm FULL SIZE AT A3					
Freeborn Place, Alstonville, NSW.					

greenlight DESIGN
MG Planning & Design Solutions Pty Ltd t/a Greenlight Design
A/N 62 314 464 888 Brunswick St, Forthside Valley 4006
S/N 62 314 464 888 P 07 3315 2720 F 07 3315 2725

Ridgemill Project Management
Suite 3, 29 McDougall Street,
Parramatta NSW 2150
P 07 3368 4911



Examples of Improved Facility Elements

The following images provide examples of the range of improvements suggested for the redevelopment of the swimming pool complexes. These examples are indicative only and will not necessarily form part of the final design.



wet deck edge



freeform pool with zero entry

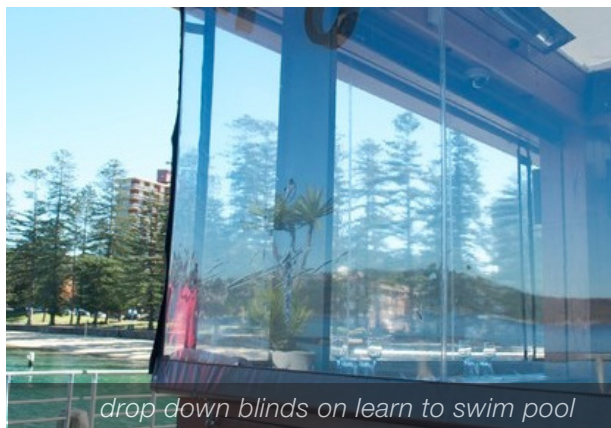

drop down blinds on learn to swim pool



BBQs and gazebos



seating shade around 50m pool



tiered seating around 50m pool

Further information

If you would like to know more about this project please contact:

Mr Jordan Robinson, Manager Community Facilities and Customer Service

Ballina Shire Council

Ph: 02 6686 4444

Email: jordanr@ballina.nsw.gov.au

ballina.nsw.gov.au