

KINGSFORD SMITH DRIVE AND THE SPIT:  
SAILING CLUB TO MISSINGHAM PARK

THE RATIONALE

*To enhance what is already a popular foreshore area with a focus on establishing a pedestrian friendly environment and enriching the potential experience of the foreshore environment. Proposals for the link between the Sailing Club and Missingham Park could enhance this easily accessible foreshore location and create a foreshore linear park that*

- provides for the safe use of the path by pedestrians and cyclists by adopting landscape strategies to separate vehicular movement and pedestrian/cycle movement;
- contributes to the amenity of Kingsford Smith Drive as a significant local road;
- reinforces this area as a key link in the pathway network and as an active space;
- provides for the comfort of users;
- offers a range of environmental and visual experiences;
- provides appropriate beach accesses; and
- contributes to the rehabilitation of the dune and spit.

THE PROPOSALS

Provide for the safe use of the path by pedestrians and cyclists

This location represents an opportunity for easy access to the foreshore and water and subsequently parking occurs along most of the length of the link between the Sailing Club and Missingham Park. Current parking occurs in an informal manner and there is no barrier between parking areas, shade trees and the path. Car parking in this current form represents a hazard to pedestrians and cyclists and is also causing compaction of the grassed areas and tree roots along the walkway.

It is proposed a variety of landscape strategies be adopted to define car parking areas and to separate vehicles from path users. Car parking areas would be defined by a combination of street furniture and landscaping. Low mounds, landscaping and tree planting would separate these areas from the path. These strategies would also provide some separation between the foreshore walk and Kingsford Smith Road, enhancing the walking/cycling experience.

Kingsford Smith Drive as a shaded avenue

The walkway has some shade trees but many parts of the route are hot and exposed. Kingsford Smith Drive and the adjacent foreshore area has a focus on vehicles. It is proposed extensive tree planting be undertaken along the road. An avenue of trees will define Kingsford Smith Drive as a significant route and will provide shade to the foreshore walk.



Reclaim part of The Spit as a revegetated dune walk and art setting

The sandy beach that commences at the boat ramp and extends around to Missingham Park is popular with families for swimming, playing and fishing. The western most beach area and the beach close to Missingham Park are very popular. The broad central beach area represents a long walk to the water at low tide and can be hot to walk in the warmer months. This area is showing signs of natural regeneration with spinifex and other coastal groundcovers starting to re-establish.

It is proposed this area be reclaimed as vegetated dune. Revegetation should reflect native/endemic coastal vegetation including *Banksias* and *Casuarinas*. In the long term, this new vegetated area could provide a shaded beach access and a different environmental experience.

It is proposed the ‘Spit Boardwalk’ be located through this revegetated area to provide an alternative beach access. The boardwalk could also provide a setting for public artworks. The boardwalk journey could be enriched by artworks that are gradually revealed amongst groves of Casuarina and Banksia trees.

The existing dog off-leash area would be retained on The Spit beaches, but dogs off-leash would be excluded from the path and boardwalk.



The Missingham Art Trail

It is proposed the link between the Sailing Club and Missingham Park becomes a public art trail. The enhanced walkway and reclaimed vegetated area of Missingham Spit presents a variety of settings for potential artworks. The art trail may be a temporary piece similar to

Sydney’s Sculptures by the Sea or it may feature permanent artworks. The range of environmental settings could provide inspiration for artworks. Sculptures or installations could be located along the walkway, in the dunes amongst vegetation, along ‘The Spit Boardwalk’, on the beach or at the waters edge.

The art trail has the potential to draw upon the uniqueness of Ballina, its natural landscapes, its cultural past and present and its vibrant character as a coastal centre.



The dune area is degraded with informal beach accesses and weed growth. It is proposed a number of beach accesses are formalised with signage, surfacing such as board and chain and fencing to protect the adjacent vegetation. A rehabilitation program should be adopted that sees degraded areas weeded and revegetated to protect the fragile coastal landscape.

At the northern end of the pathway as it enters Missingham Park, the large car park represents an exposed location with a vast hard surface and no shade. It is proposed trees be located along the western and eastern side of the car park to provide shade and a ‘green’ interface between the car park and foreshore.

Increase the recreational value of the foreshore

Providing separation between the pedestrian/cycle path and vehicles will enhance the experience of using this pathway. It would then be more appropriate to provide seating and viewing locations along the route. Beach accesses could be treated as nodes with signage, showers and seating. The entry to ‘The Spit Boardwalk’ could also be a node with a sculptural element.

Design for Longevity

The design of any infrastructure or artwork installations must recognise that The Spit represents a location subject to coastal dynamics and shoreline variability. Any infrastructure or facilities at this location must be designed to address this issue and to provide for the longevity and ongoing maintenance of those items.







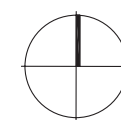
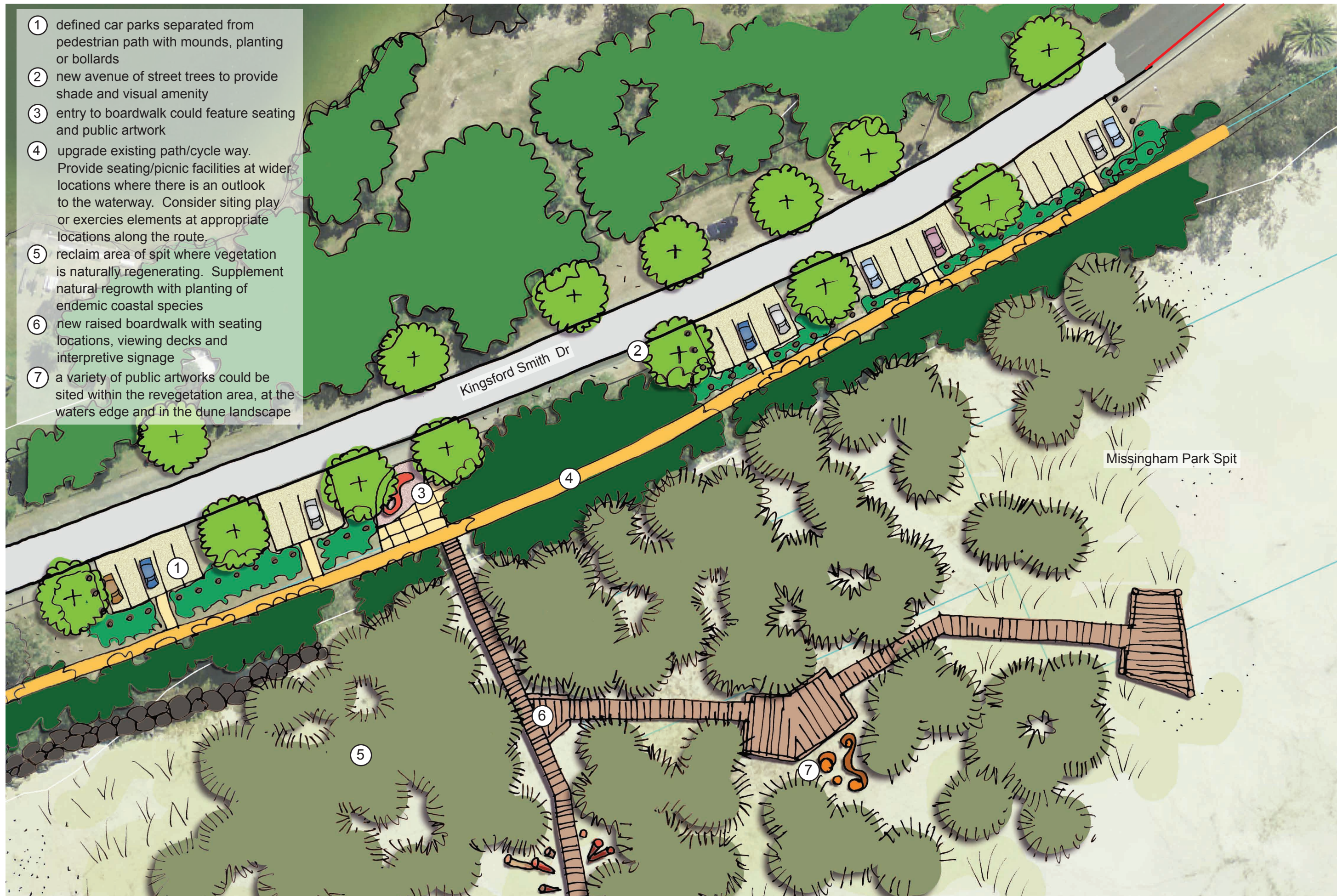



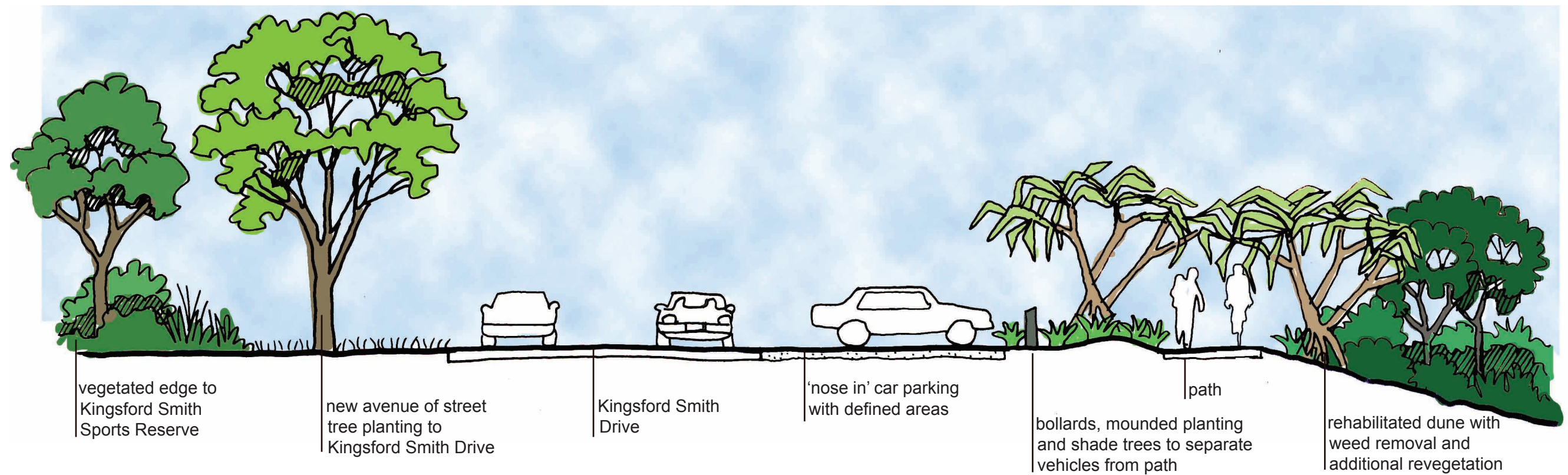

**B** MISSINGHAM TRAIL AND KINGSFORD SMITH DRIVE

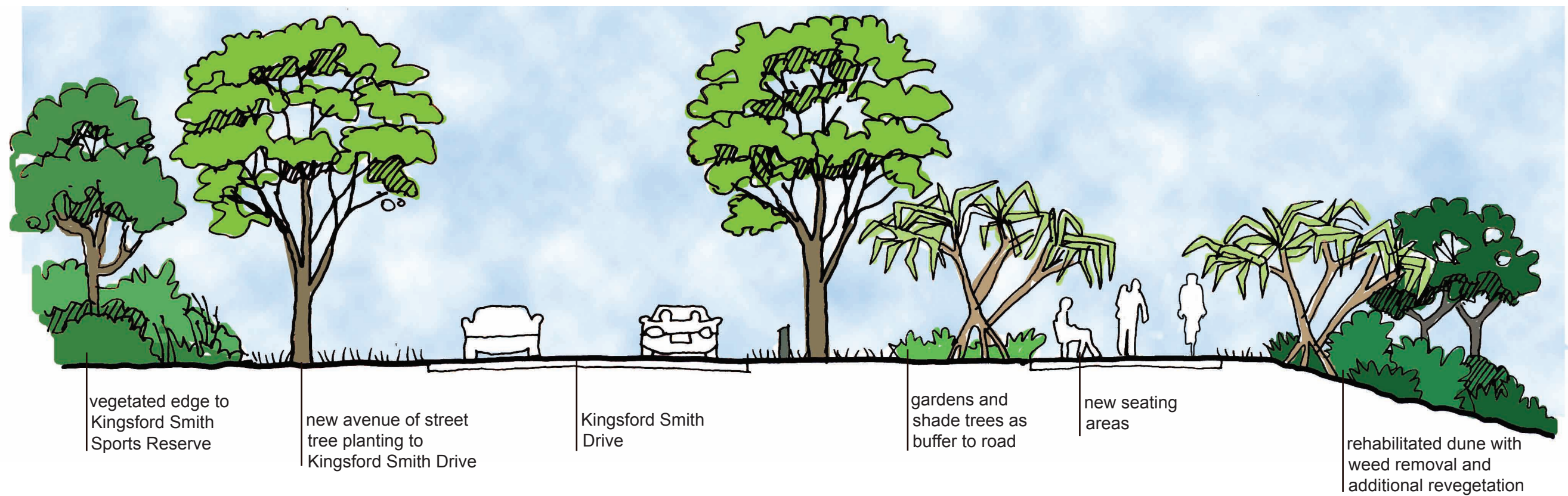

**C** MISSINGHAM TRAIL AND KINGSFORD SMITH DRIVE





MISSINGHAM TRAIL